

Advance Workshop Steel Introduction

Solutions for ON-DEMAND MANUFACTURING business A MES++ or ERP-
Payroll – general ledger Solution



+1000 factories AW



+50 countries



Presales Experts

WHAT'S ADVANCE WORKSHOP

Multi-Architecture

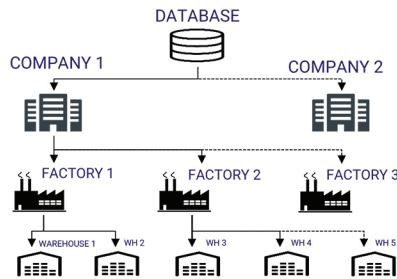

Functional Coverage



Supply Chain Management

- Sales
- Purchase
- Jobsites
- Credit control
- Business margins
- Invoicing



Technical Office Management

- Estimations
- BIM integration
- Drawings
- CAD scanning
- BOM orders



Production and realtime Monitoring

- Raw material traceability
- Nesting
- Machine Downloading
- Manufacturing strategy
- Order status
- Run optimization



Stock & Logistics

- 2 Stock levels
- MRP1/2
- Routes optimization
- Stock locations
- Truck loading control

Technology



Integration



ERP Functionalities



Supply Chain Management

- Sales management:
- › Customers.
 - › Sales teams, budgets and pricing.
 - › Quotations and estimates
 - › Delivery notes creation and Invoicing.

- Purchases management:
- › Budgets and orders.
 - › Entry notes creation.
 - › Received invoices checker.

Business costing management.

ERP standard connectors to integrate your business.



Technical Office Management

Stock management, theoretical mix consumption and customer raw material reservations.

Heat traceability assignment.

Reports and tags printing.

Control variables creation.

Control models creation.

Quality tests will appear on MACHINE TOUCHBOX screen.



ERP Parametrization

Multi-company, multi-branches, multi-warehouse architecture.

User's rights group (admin., sales, purchases, technical, production, etc.).

Password on key processes.

- Global parameters:
- › Kernel management 30 parameters.
 - › Supply chain management 60 parameters.
 - › Logistics management 20 parameters.
 - › Stock & Quality management 30 parameters.



Logistics

Truck route optimization with Google Maps®.

Truck occupancy planning.

Transport rates and costs.

Automatic calculation of production and delivery date.

Truck loading control of all the products and trading.

Steel Functionalities

TECHNICAL OFFICE MANAGEMENT

Complete compatibility with Advance Steel and IFC's

Import of assembled parts and elements with SMLX and NC WISCON files

Creation and scheduling of your production orders

BOM viewer

Importation resume

Import interface for your models with selection criteria

Integrated 3D part visualization tool

Material	Number	Weight (kg)
Arrière	53	8 883,00
Arrière	5	0,00
Arrière	2	130,21
Plafond	20	2 201,41
Plafond	5	0,00
Plafond	4	112,10
Plafond	1	0,00
Plafond	20	897,00
Plafond	5	0,00
Plafond	3	4,74
Plafond	200	0,00
Plafond	1	0,00
Plafond	11	0,00
Plafond	5	0,00
Plafond	2	0,00
Plafond	11	0,00
Plafond	2	0,00
Plafond	1	0,00

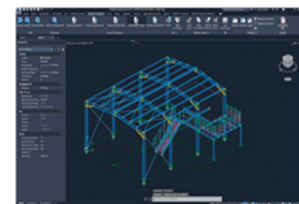

PRODUCTION MANAGEMENT

Specified delivery	Production sequence / Order	Sequence/Order name	Intitule	Total weight (kg)	Operations Progress	Loading progress
15/09/2020	08K20 - 11 / SEQ-0832	VIGAS PFC10 4	OBRA - CALAMAR	6,10	100%	100%
14/09/2020	08K20 - 11 / SEQ-0834	VIGAS TESTE	OBRA - CALAMAR	6,86	100%	100%
14/09/2020	08K20 - 11 / SEQ-0835	TESTE NR	OBRA - CALAMAR	6,86	100%	100%
14/09/2020	08K20 - 11 / SEQ-0836	Vigas teste	OBRA - CALAMAR	6,70	100%	100%
14/09/2020	08K20 - 11 / SEQ-0837	VIGAS PL1	OBRA - CALAMAR	6,98	100%	100%
14/09/2020	08K20 - 11 / SEQ-0838	VIGAS 2 PL1	OBRA - CALAMAR	6,01	100%	100%
21/09/2020	08K20 - 11 / SEQ-0839	a 1	OBRA - CALAMAR	6,10	100%	100%
12/10/2020	08K20 - 11 / SEQ-0844	VIGAS 1 A 3	OBRA - CALAMAR	6,10	100%	100%
13/10/2020	08K20 - 11 / SEQ-0845	VIGA 4	OBRA - CALAMAR	6,21	100%	100%
12/10/2020	08K20 - 11 / SEQ-0846	VIGAS 5	OBRA - CALAMAR	6,09	100%	100%

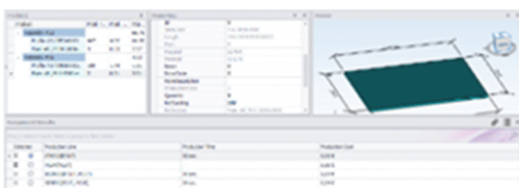

Nesting module

- › Management and reuse of scraps
- › Management of production cycles from several sequences to minimise scraps production and increase productivity

Automatic allocation of machines according to economic and technical criteria

- › Automatic downloading of machines
- › Management of machine maintenance

On-line production monitoring

- › On-line monitoring of the progress of customer sequences and production phases
- › Real-time production monitoring of machines and operators

Automatic assignment of raw materials for traceability

- › TOUCHBOX hardware kit for interfacing with machines
- › Creation of labels and production editions