

Advance Workshop Rebar Introduction

Solutions for ON-DEMAND MANUFACTURING business A MES++ or ERP-
Payroll – general ledger Solution



+1000 factories AW



+50 countries



Presales Experts

WHAT'S ADVANCE WORKSHOP

Multi-Architecture

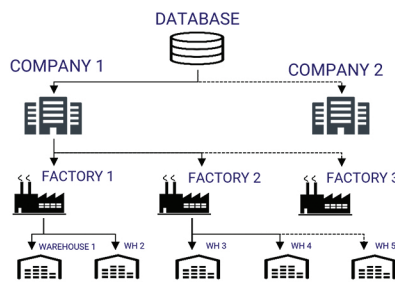

Functional Coverage



Supply Chain Management

- Sales
- Purchase
- Jobsites
- Credit control
- Business margins
- Invoicing



Technical Office Management

- Estimations
- BIM integration
- Drawings
- CAD scanning
- BOM orders



Production and realtime Monitoring

- Raw material traceability
- Nesting
- Machine Downloading
- Manufacturing strategy
- Order status
- Run optimization



Stock & Logistics

- 2 Stock levels
- MRP1/2
- Routes optimization
- Stock locations
- Truck loading control





Technology



Integration



ERP Functionalities

 <h3>Supply Chain Management</h3> <p>Sales management:</p> <ul style="list-style-type: none"> Customers. Sales teams, budgets and pricing. Quotations and estimates Delivery notes creation and Invoicing. <p>Purchases management:</p> <ul style="list-style-type: none"> Budgets and orders. Entry notes creation. Received invoices checker. <p>Business costing management.</p> <p>ERP standard connectors to integrate your business.</p>	 <h3>Technical Office Management</h3> <p>Stock management, theoretical mix consumption and customer raw material reservations.</p> <p>Heat traceability assignment.</p> <p>Reports and tags printing.</p> <p>Control variables creation.</p> <p>Control models creation.</p> <p>Quality tests will appear on MACHINE TOUCHBOX screen.</p>	 <h3>ERP Parametrization</h3> <p>Multi-company, multi-branches, multi-warehouse architecture.</p> <p>User's rights group (admin., sales, purchases, technical, production, etc.).</p> <p>Password on key processes.</p> <p>Global parameters:</p> <ul style="list-style-type: none"> Kernel management 30 parameters. Supply chain management 60 parameters. Logistics management 20 parameters. Stock & Quality management 30 parameters. 	 <h3>Logistics</h3> <p>Truck route optimization with Google Maps®.</p> <p>Truck occupancy planning.</p> <p>Transport rates and costs.</p> <p>Automatic calculation of production and delivery date.</p> <p>Truck loading control of all the products and trading.</p>
--	--	---	--

Rebar Functionalities

TECHNICAL OFFICE MANAGEMENT

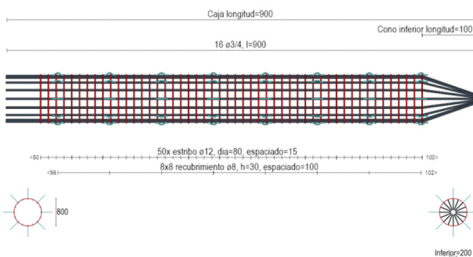

Jobsites management

Drawings detailing:

- Barmark list.
- Macro designer.
- Welding scheme

RebarScan- Detailing and drawing scanning to on AutoCAD.

- Beams, columns, walls, slabs.
- Slab designer: every kind of area, with elevator and stair shafts, even arch segments.
- Design and importation of variable elements.

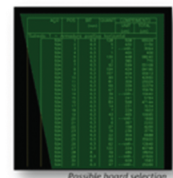
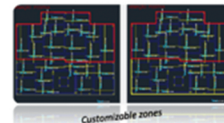
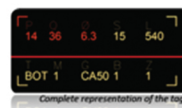

ID	AS	10	50	HA	10	5001	Non	40	580	58735.78	0	0	1	0	01	10	4	0		
1	0	005	AS	10	50	HA	10	5001	Non	40	580	58735.78	0	0	1	0	01	10	4	0
2	0	006	AS	10	50	HA	8	3003	Non	30	379	37914.97	0	0	1	0	0	0	0	0
3	0	007	AS	10	50	HA	8	2011	Non	30	118	1184.661	0	0	1	0	0	0	0	0
4	0	008	AS	3	15	HA	16	1042	Non	15K	464	46021.49	0	0	1	0	0	0	0	0
5	0	009	AS	2	10	HA	20	0002	Non	0	400	40019.72	0	0	1	0	0	0	0	0

FastRebar - Your customer does detailings for you

- Offline, downloadable from your site.
- Self-installing and configurable.
- Client users and downloads are not limited.

BIM importation module - Get automatically rebars from IFC BIM model

- Automatic drawing importation from BIM IFC.
- The work schedules its own orders and displays them on-line.
- The tool is implemented in the customer's own technical office and is synchronized with your production AW.

PRODUCTION MANAGEMENT

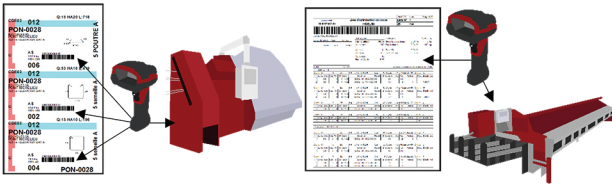
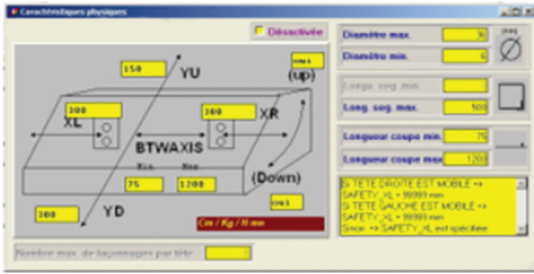

- Production online monitoring of BBS and Runs.
- Production online monitoring of machinery and operators.
- Machine maintenance management.
- Automatic raw material heat assignment for traceability.
- TOUCHBOX hardware kit for interface with machines.

Online production follow up.

Automatic machine downloading by tag or full list.

Full optimization module depending on cutting machine.

Optimization to stock and different commercial lengths
Off-cut availability management and reutilization.

Automatic machinery affectation considering economic and technical criteria.

Production run management from several sequences to minimize scrap generation and increase productivity.

Call off	Job no	Total weight (T)	Assemble weight (A)	Loading %	CB Progress	CB Hour % CB	Assemble progress	Assemble Hour	Assemble %	Loading progress
COOK-241 (2) 40 BARREN/QUILMILL	1.00	0.00	0.00	0.00	0.00	0%	0%	0%	0%	0%
WDC-41 600000 40H	1.00	0.00	0.00	0.00	0.00	0%	0%	0%	0%	0%
WDC-41 (2) 401 KENTALAC	0.00	0.00	0.00	0.00	0.00	0.00%	0%	0%	0%	0%
WDC-41 (2) 402 899 00005	3.70	3.70	3.67	0.00	0.00	0.00%	0%	0%	0%	0%
COOK-108 (2) 40 STAFF GCC SAC ANTON	2.50	2.50	2.47	0.00	0.00	0.00%	0%	0%	0%	0%
COOK-108 (2) 40 STAFF GCC SAC ANTON	0.20	0.20	0.19	0.00	0.00	0.00%	0%	0%	0%	0%
COOK-1 (2) 404 GCC OPOT 849-7500	0.30	0.30	0.29	0.00	0.00	0.00%	0%	100%	0%	0%
COOK-108 (2) 40 STAFFANHC KJ040H R	2.00	2.00	1.98	0.00	0.00	0.00%	0%	0%	0%	0%
COOK-47 (2) 401 8304025 SAKT-GUENEC	3.00	3.00	2.95	0.00	0.00	0.00%	0%	100%	0%	0%
COOK-47 (2) 401 8304025 SAKT-GUENEC	0.00	0.00	0.00	0.00	0.00	0.00%	0%	0%	0%	0%
WDC-11 (2) 404 4000005	0.00	0.00	0.00	0.00	0.00	0.00%	0%	0%	0%	0%

Mesh Functionalities

TECHNICAL OFFICE MANAGEMENT

Automatic mesh slab designing & optimization

- Standard mesh & Cold drawing management
- Quotations
- BOM & Orders
- Production
- Stock management: MRP

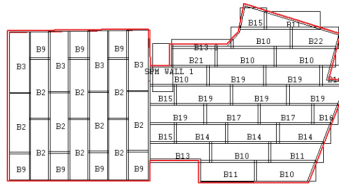

Cut & Bend of mesh elements

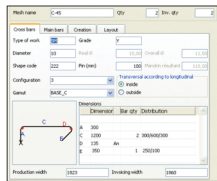

1st Choose the final element shape and transversal dimensions

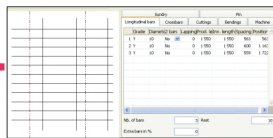

2nd Type longitudinal dimensions

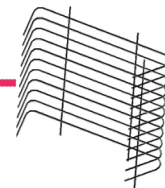

3rd Watch the final element with the 3D viewer

PRODUCTION MANAGEMENT

- Online production follow up.
- Automatic machine downloading by tag or full list.
- Straightening and mesh machines affectation.
- Production run management from several sequences to minimize scrap generation and increase productivity.
- Production online monitoring of BBS and Runs.
- Production online monitoring of machinery and operators.
- Machine maintenance management.
- Automatic raw material heat assignment for traceability.
- TOUCHBOX hardware kit for interface with machines.